

5mm ROUND INTERNAL THREAD HANDLES

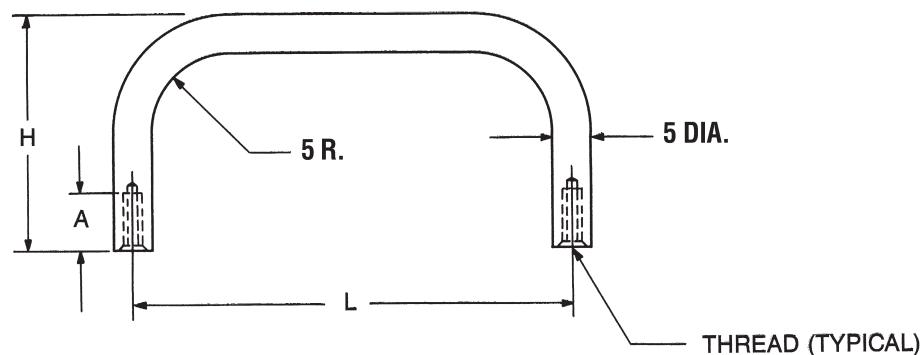

PART NO.	L ±1.0	H ±1.0
M6060	38	16
M6061	44	
M6062	51	
M6063	76	
M6064	102	
M6065	127	
M6066	25	19
M6067	32	
M6068	38	
M6069	44	
M6070	51	
M6071	76	
M6072	102	
M6073	127	
M6074	25	22
M6075	32	
M6076	38	
M6077	44	
M6078	51	
M6079	76	
M6080	102	
M6081	127	
M6082	25	25
M6083	32	
M6084	38	
M6085	44	
M6086	51	
M6087	76	
M6088	102	
M6089	127	

PART NO.	L ±1.0	H ±1.0
M6090	25	29
M6091	32	
M6092	38	
M6093	44	
M6094	51	
M6095	76	
M6096	102	
M6097	127	
M6098	25	32
M6099	32	
M6100	38	
M6101	44	
M6102	51	
M6103	76	
M6104	102	
M6105	127	
M6106	25	38
M6107	32	
M6108	38	
M6109	44	
M6110	51	
M6111	76	
M6112	102	
M6113	127	

See page 6M for finish codes

For non-standard parts contact Sales Office

ORDERING CODE			
MXXXX	XXXX	XX	XX
LENGTH & HEIGHT	THREAD	MATERIAL	FINISH

THREAD CODE & DEPTH		
THREAD	CODE	A
M3x0.5	3005	6
M3.5x0.6	3506	8-10

MATERIAL	CODE	RoHS
Aluminum	A	YES
Brass	B	YES
Stainless Steel	SS	YES



RAF ELECTRONIC
HARDWARE

95 Silvermine Road, Seymour, Ct. 06483 Phone: 203-888-2133 Fax: 203-888-9860
e-mail : info@rafhdwe.com Web: www.rafhdwe.com